

## **SET 2-3**

- Set of 52 m x 21 m x 7 m (height).
- Set area: 1092 m<sup>2</sup>
- Cyclorama with "L" shape of 18 m (frontal) x 6 m (height); 15 m (right) x 6 m (height).
- 28 metal structures (6 m x 3 m) for illumination adjustable in height and inclination.
- Cement floor and Plasterboard cyclorama.
- Current supply of 200 kW (**Servicevision will not be responsible for any kind of problem related with electric supply**).
- Set of two doors of 5,5m x 4m.
- 2 Rooms, one of 11 m<sup>2</sup> and the other of 30 m<sup>2</sup>. WI-FI are included.
- 2 Dressing rooms.
- 2 restrooms with a toilet and a sink.
- 2 Bathrooms with a toilet, sink and a shower (with hot water).
- Sets officer from 8:00 am to 8:00 pm.
- Water source
- fridge

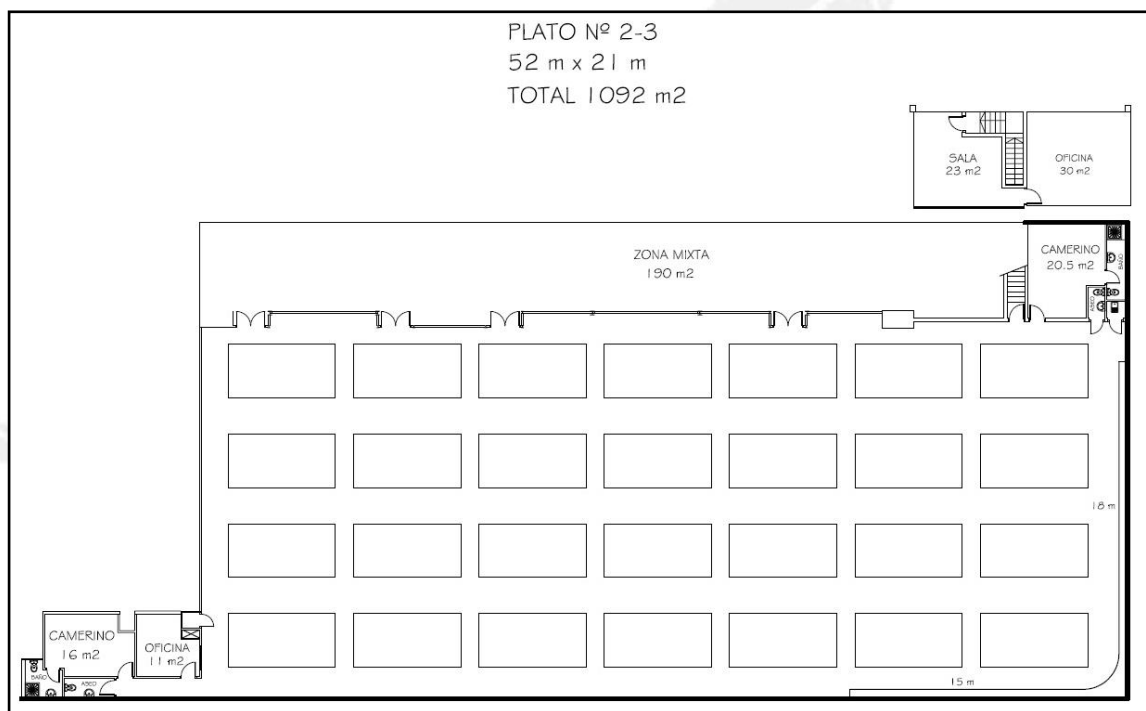

### **General conditions:**

- *The costs for any paint for the cyclorama is not included and must be assumed by the user.*
- *If it's necessary to paint on the floor set outside the painted area should be done on overlapping base and removed it at the end of the filming.*
- *Private and exclusive access to the Set 1 and 2-3. Vehicle parking and material storage are not allowed in this area*
- *Total weight of the vehicles must not exceed 7,500 kg, any truck of more than 7 m in length will be unloaded from the aisle without access within the set.*
- *The maximum permissible weight on the set is 1000 kg per m<sup>2</sup>.*
- *Working with minors: Any collaboration of minors under 16 years of age must have the prior express authorization of the Departament d'Empresa i Ocupació de la Generalitat de Catalunya. The producer concerned is responsible for its processing and compliance.*
- *Working with animals: The professional in charge of the animal will be responsible for keeping all vaccines up to date, requesting all permits, corresponding licenses and controlling the safety around them.*
- *Shooting with smoke: The person in charge of set will be warned in advance.*
- *Any complementary power generator must be parked and operate from the street.*

### **Usage specifications:**

- *The personnel list will be sent to the Set Officer, at least one day in advance.*
- *Painting the cyclorama is not included in the rental of the set.*
- *The color of the cyclorama will be the one left by the last user. In case of willing to take advantage of the painting it is advisable to check it before the day of filming.*
- *Any dark colors must be repainted in white at the end of filming.*
- *Set cleaning and decoration removal is on charge of the user. The set must remain clean and empty once the filming is finished.*

### **Accessories**

- *Movable roof of 9.5 m x 9.5 m to reflect the light (in White)*
- *Production equipment: Tables, chairs, iron, steamer, coat racks...*
- *2 movable white wood panels 8 m x 5 m*

## **Price list**



- Shooting day, from 8:00am to 8:00pm.....	1500€
- Day of assembly or dismantle, from 8:00am to 8:00pm .....	750€
- Extra hour of the set (including Set Officer).....	110€
- Chair rental (price for day).....	1.25€
- Table rental (price for day).....	6€
- Movable roof 9.5 m x 9.5 m (price for day).....	400€
- Movable white wood panel (price for day).....	100€
- Shoe cover (100 units).....	10 €
- White paint can.....	75€

## **Cancellation policy:**

- 25% 72 h\* before rental.
- 50% 48 h\* before rental.      (\*) From Monday to Friday
- 100% 24 h\* before rental.
- Not included IVA or any service not specifically consigned. It must be paid in cash.
- The customer will take care of any kind of damage lamps. The customer will contribute with the own insurance of persons and material goods
- **SERVICEVISION is not responsible of the lost or stealing of any material or personal belongings during the days of set usage.**